

荆溪镇22.25亩物流仓储用地项目红线图  
2890.5-40424.6

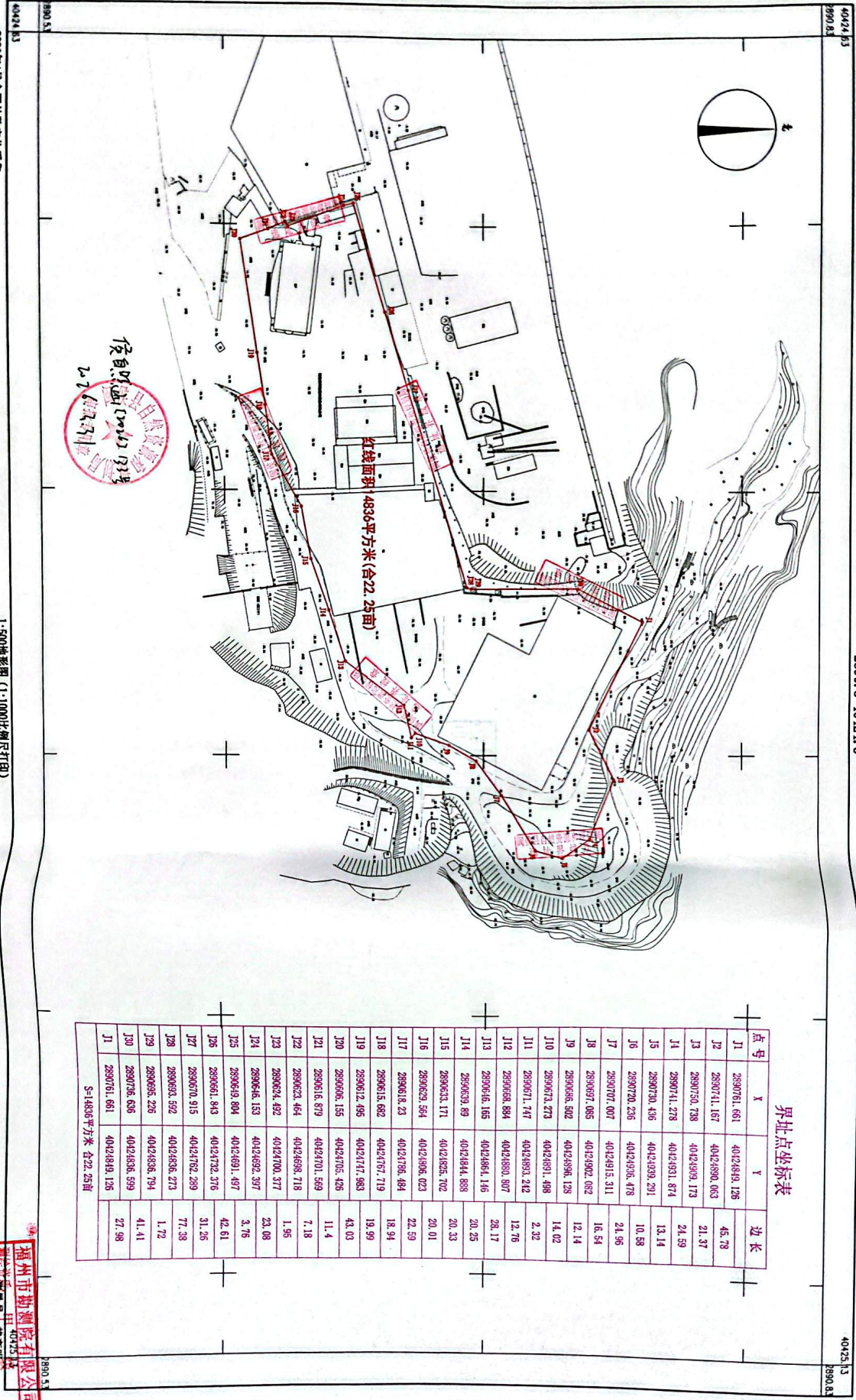

界址点坐标表

点号	X	Y	边长
J1	2890761.661	40424849.126	45.73
J2	2890741.167	40424890.063	21.37
J3	2890750.738	40424939.173	24.59
J4	2890741.278	40424931.874	13.14
J5	2890730.436	40424939.291	10.88
J6	2890720.236	40424936.478	24.96
J7	2890707.007	40424915.311	16.54
J8	2890697.085	40424902.082	12.14
J9	2890686.502	40424896.128	14.02
J10	2890672.273	40424891.488	2.32
J11	2890671.747	40424893.242	12.76
J12	2890668.884	40424890.807	28.17
J13	2890646.165	40424861.146	20.25
J14	2890639.89	40424844.888	20.33
J15	2890633.171	40424825.702	20.01
J16	2890629.564	40424806.023	22.59
J17	2890618.23	40424786.484	18.94
J18	2890615.682	40424767.719	19.99
J19	2890612.465	40424747.883	43.03
J20	2890606.155	40424705.428	11.4
J21	2890616.679	40424701.569	7.18
J22	2890623.464	40424698.718	1.95
J23	2890624.492	40424700.377	23.08
J24	2890646.153	40424692.397	3.76
J25	2890649.804	40424691.497	42.61
J26	2890661.843	40424732.376	31.26
J27	2890670.915	40424702.289	77.38
J28	2890693.592	40424836.273	1.72
J29	2890695.226	40424836.794	41.41
J30	2890726.656	40424836.599	27.98
J1	2890761.661	40424849.126	

S=14306平方米 合22.25亩

1:500地形图 (1:1000比例尺打印)

福州市勘测院有限公司  
地址: 福州市晋安区...  
资质证书编号: 1000175  
发证机关: 福建省自然资源厅

2026年4月全野外数字化采集  
CGCS2000坐标系, 中央子午线120°  
步长高程果, 等高距为1米, 2017版图式。

福州市勘测院有限公司