

两园南LYN-A-05f地块勘测定界图

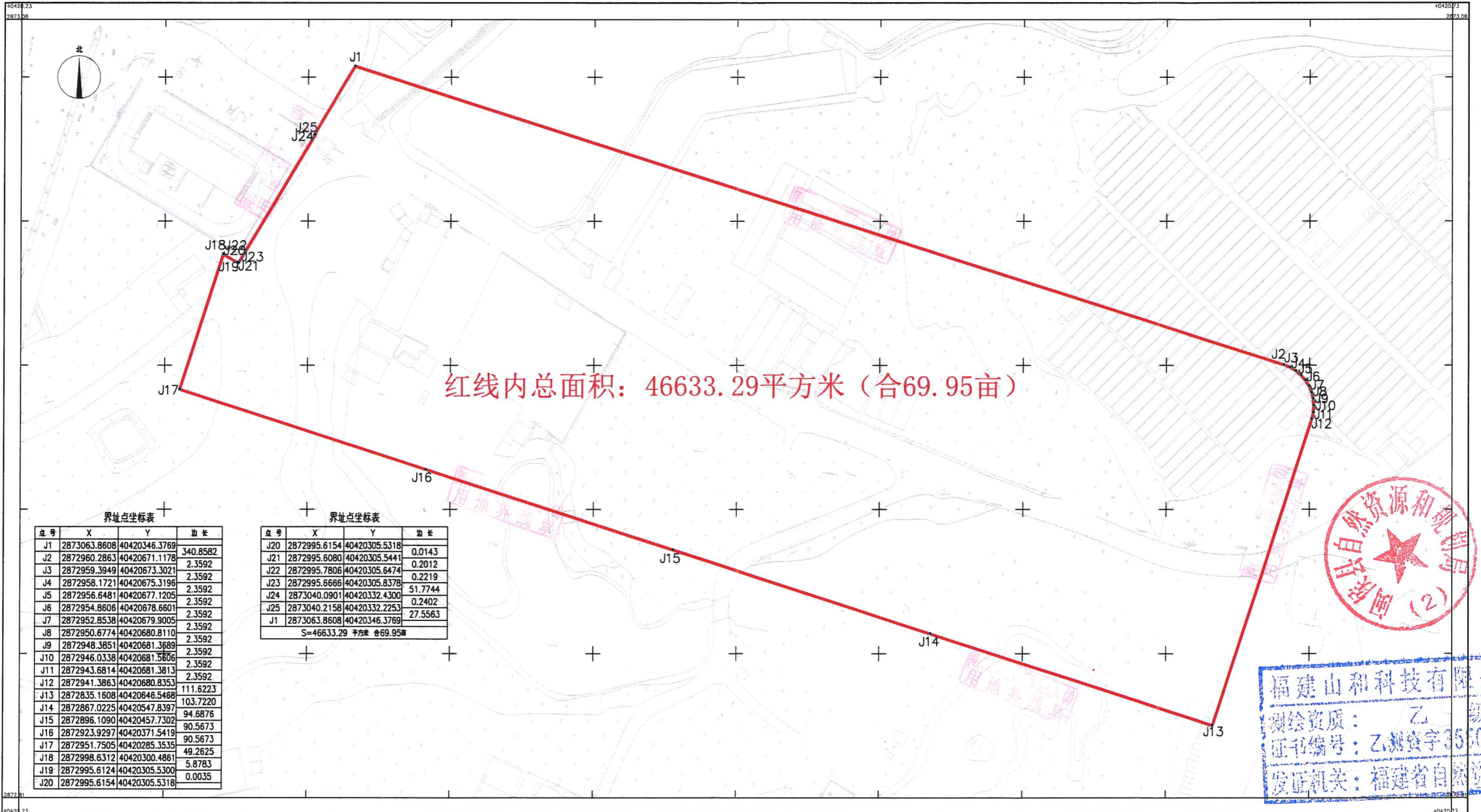

界址点坐标表

点号	X	Y	边长
J1	2873063.8608	40420346.3769	340.8582
J2	2872960.2863	40420671.1178	2.3592
J3	2872959.3949	40420673.3021	2.3592
J4	2872958.1721	40420675.3196	2.3592
J5	2872956.6481	40420677.1205	2.3592
J6	2872954.8606	40420678.6601	2.3592
J7	2872952.8538	40420679.9005	2.3592
J8	2872950.6774	40420680.8110	2.3592
J9	2872948.3851	40420681.3689	2.3592
J10	2872946.0338	40420681.5606	2.3592
J11	2872943.6814	40420681.3813	2.3592
J12	2872941.3863	40420680.8353	2.3592
J13	2872835.1608	40420646.5468	111.6223
J14	2872867.0225	40420547.8397	103.7220
J15	2872896.1090	40420457.7302	94.6876
J16	2872923.9297	40420371.5419	90.5673
J17	2872951.7505	40420285.3535	90.5673
J18	2872998.6312	40420300.4861	49.2625
J19	2872995.6124	40420305.5300	5.8783
J20	2872995.6154	40420305.5318	0.0035

界址点坐标表

点号	X	Y	边长
J20	2872995.6154	40420305.5318	0.0143
J21	2872995.6080	40420305.5441	0.2012
J22	2872995.7806	40420305.6474	0.2219
J23	2872995.6666	40420305.8378	51.7744
J24	2873040.0901	40420332.4300	0.2402
J25	2873040.2158	40420332.2253	27.5563
J1	2873063.8608	40420346.3769	27.5563
S=46633.29 平方米 合69.95亩			



福建山和科技有限公司
 测绘资质: 乙 级
 证书编号: 乙测资字 35000228
 发证机关: 福建省自然资源厅